

SUBMITTAL: LP- 5 SAFETY POST FOR LADDERS

The LP- 5 Safety Post provides a convenient and safe method of climbing off and onto fixed access ladders.

Easy to Install: The LP- 5 Safety Post comes pre-assembled and attaches directly to the top two rungs square or round) with two U-shaped bolts.

Easy to Use: When at the top of the ladder extend the safety post. The spring coil allows user to lift with just one hand. Step on or off the ladder in a safe standing position while holding onto the post. A latch maintains the post at variable heights and is easily released for retracting the pole.

Safety features: Include a square post for a no slip grip and a ring at top for a harness. We recommend a [Saf-T-Hatch](#) rail system in addition to the Safety Post for greater safety.

Weight: 25 lbs.

Finish: Hot dip galvanized. (See LP-4 for Powder-Coat Painted Safety Yellow Finish)

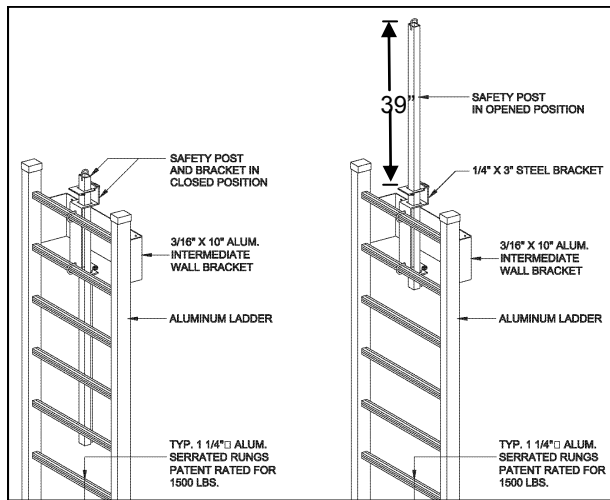
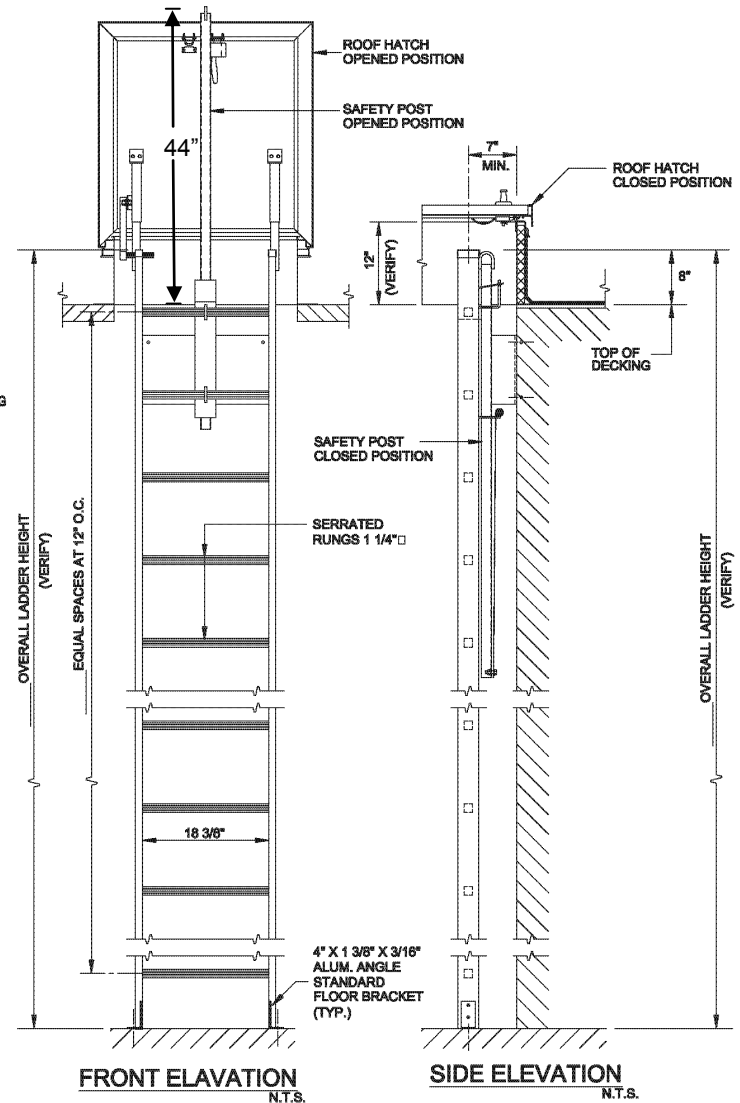
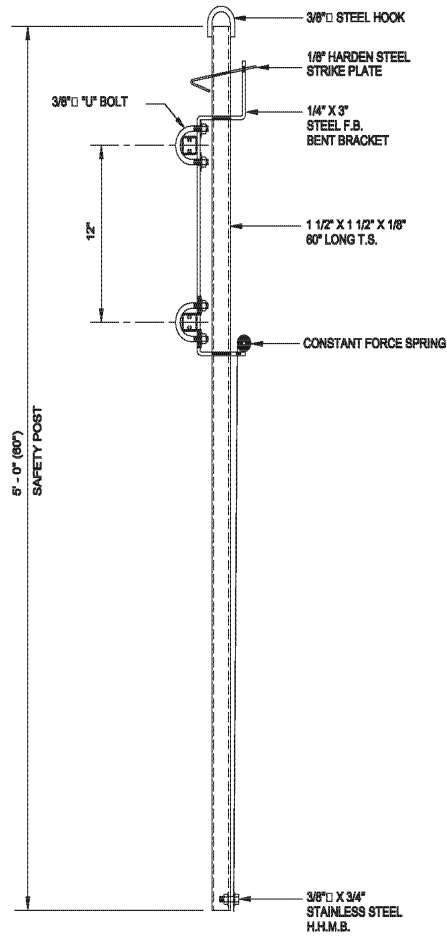

Distributor:	Quantity:
Contractor:	Approved By:
Model #:	Architect:
Project:	Date:



Distributed by

www.Ameraproducts.com

Phone: (800) 608-6568

Fax: (409) 840-5545

info@ameraproducts.com