

SUBMITTAL: STAINLESS STEEL CORNER GUARDS - CGS SERIES

Our satin finish stainless steel corner guards provide durable protection which is ideal for restaurants, commercial kitchens, hospitals and schools.

SPECIFICATIONS

Material: Type 304 stainless steel , 18 gauge.

Finish: US32D #4 satin (BHMA 630).

Angle: 90° or 135° 1/8" radius. Other angles optional.

Length: 48" standard", up to 108".

Flame Resistance: Non-flammable.

Edges: Standard 1/2" eased vertical edges with top radius corners and bottom square corners.

Compliance: Meets ASTM A240-7

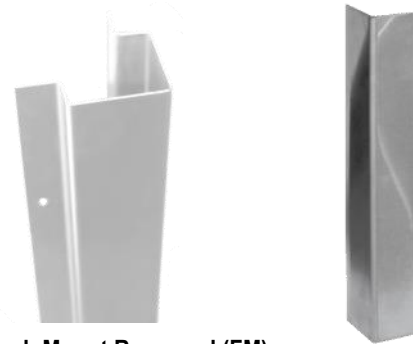

Flush Mount Recessed (FM)

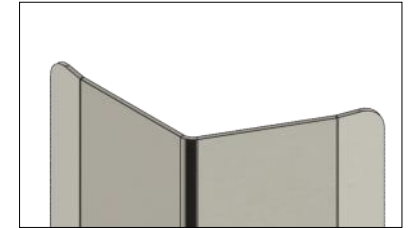

Top Radius Corners

Notes: Corner guard installation methods

1. Construction adhesive, ordered separately below or provided by others in the field.
2. Adhesive backed tape (T), factory-applied - select below.
3. Mechanically with screws and countersunk holes (H) - select below.

OPTIONAL FEATURES— CHECK HERE AND FILL IN TABLE BELOW:

- | | |
|---|---|
| <input type="checkbox"/> (T) Double-Sided Tape | <input type="checkbox"/> (H) Countersunk Holes w/Screws |
| <input type="checkbox"/> (14G) 14 Gauge | <input type="checkbox"/> (CGSH) 16 Gauge |
| <input type="checkbox"/> Non-standard Angle: _____° | <input type="checkbox"/> #7 Polished Finish |
| <input type="checkbox"/> (NR) Non Radius Corners Both Ends | <input type="checkbox"/> (BN) 3/4" Bullnose Radius Corner |
| <input type="checkbox"/> (FM) Flush Mount Recessed 5/8" for Under-Drywall Mount 16 Gauge | |
| <input type="checkbox"/> (CG-KIT-ADH-PL) PL375 Off White Water-based Construction Adhesive. | |
- 10 oz tube for approximately 30 linear feet.

STANDARD SIZES 18 GAUGE CORNER GUARD WITH EASED EDGES - 48" LENGTHS * ITEMS IN MN STOCK FOR 48 HR SHIP		
QTY	Wing	Part Number - 48"
	1-1/2"	CGSS90-1.5E-48*
	2"	CGSS90-2E-48*
	2-1/2"	CGSS90-2.5E-48*
	3"	CGSS90-3E-48*
	3-1/2"	CGSS90-3.5E-48*
	1-1/2"	CGSS135-1.5E-48
	2"	CGSS135-2E-48
	2-1/2"	CGSS135-2.5E-48
	3"	CGSS135-3E-48
	3-1/2"	CGSS135-3.5E-48

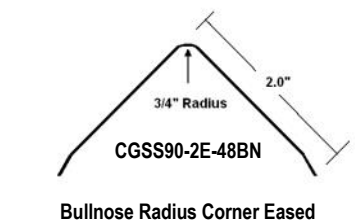
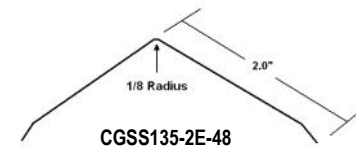
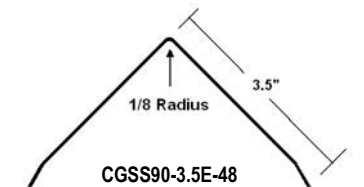

NON-STANDARD SIZES AND FEATURES						
QTY	Degree of Angle	Wing "	Eased Edge (E)	Length "	Mounting (H) (T) or Leave Blank for None	Options: BN, NR, 14G, #7
	°					
	°					
	°					
	°					

Part Number Guide:

CGSS	90	-	2.5	E	-	48	H	BN
Model	Angle		Wing	Eased Edge		Length	Mounting (H) Holes (T) Tape Blank - None	Options BN, #7, NR, 14G

Examples: CGSH90-3.5E-48T CGSS135-3-48HBN

 JL INDUSTRIES Distributed by www.Ameraproducts.com Phone: (800) 408-6568 Fax: (407) 840-3342 info@ameraproducts.com	Distributor:	Quantity:
	Contractor:	Approved By:
	Model #:	Architect:
	Project:	Date:

HEADQUARTERS: 9702 NEWTON AV S, BLOOMINGTON, MN 55431 MANUFACTURING: COMMERCE CA & BLOOMINGTON MN WAREHOUSES: SEE WEBSITE FOR LOCATIONS 3/28/2022